

OPEN REAMER

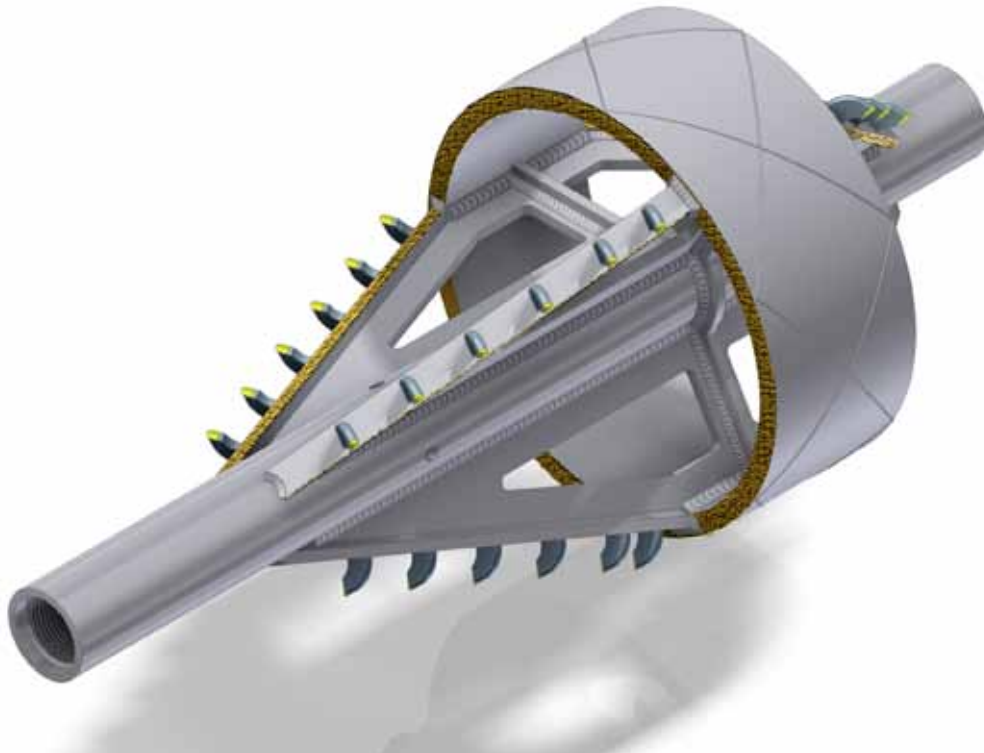

OPEN REAMERS

CODE	DESCRIPTION
ASOP200S	OPEN REAMER D200 id 90 2" 3/8 IF F/F L.780
ASOP250S	OPEN REAMER D250 id 90 2" 3/8 IF F/F L.780
ASOP300S	OPEN REAMER D300 id 90 2" 3/8 IF F/F L.780
ASOP350S	OPEN REAMER D350 id 90 2" 3/8 IF F/F L.780
ASOP400S	OPEN REAMER D400 id 114 2" 7/8 IF F/F L.1040
ASOP450S	OPEN REAMER D450 id 114 2" 7/8 IF F/F L.1040
ASOP500S	OPEN REAMER D500 id 114 2" 7/8 IF F/F L.1040
ASOP600S	OPEN REAMER D600 id 114 2" 7/8 IF F/F L.1040